



# SP4119 / SP4132

**OPERATION MANUAL | SPARE PARTS LIST**

***PNEUMATIC STEEL STRAPPING TOOL SEAL JOINT***



CE

***READ ALL INSTRUCTIONS BEFORE OPERATING THE TOOL***

**GREENBRIDGE**  
6277 HEISLEY ROAD, MENTOR, OHIO 44060  
PHONE: 440.357.1500, FAX: 440.352.9553  
[WWW.GREENBRIDGE.COM](http://WWW.GREENBRIDGE.COM)

**ED. 11/21**



## TABLE OF CONTENTS

- 1) Safety instructions
- 2) Technical data
- 3) Warranty and liability
- 4) Installation
- 5) Operating elements / adjustments
- 6) Operation
- 7) Servicing and cleaning
- 8) Troubleshooting
- 9) Layout
- 10) Spare parts list

### 1) SAFETY INSTRUCTIONS



READ THE OPERATING INSTRUCTION CAREFULLY



WHEN OPERATING THE TOOL, WEAR EYE, FACE AND HAND SAFETY PROTECTORS



GENERAL SAFETY INSTRUCTIONS :

The tool must be used by people properly trained in the use of the tool. Failure to follow the operating instructions or improper use could result in strap breakage, injuries, packages damage.

Check tool daily, do not use tool with worn or damaged parts, and use original spare parts. Never modify any tool's part.

Do not put fingers, hands or other body parts between the strap and package during the cycle.

It is your full responsibility to review the joints made by your tool, a right seal control and adjustment training will be useful to check the seal quality in order to avoid severe injury. Never move goods with bad quality seals.

Use only specific strap dispenser to dispense the strap. Keep your working area clean and always use the tool in good balance and safety conditions. Never use straps as a means of pulling or lifting goods.

To cut the straps always use proper safety strap cutter and keep other people and yourself at safe distance from strap, always stand to side of strap, away from direction that loosened strap end will go. Hold the upper strap portion and pay attention that the lower strap will snap forward away from you.

Improper operation, excessive tensioning, using straps not recommended and/or sharp corners on the package could result in a sudden loss of strap tension or in breakage that causing package / operator to fall and strap flying violently towards you. Use edge protectors if there are shaped corners, place the strap correctly around a properly positioned package, stand yourself by side of strap and keep people away, use the correct strap quality, width, thickness, and strength recommended in this manual.

Please preserve the booklet; as it is a part of the tool. This tool is manufactured without any substances which could be dangerous to health. National instructions must be observed for disposal of all the parts.



GENERAL SAFETY INSTRUCTIONS FOR COMPRESSED AIR:

Never operate this tool using a bottled air or other gas source. Always respect the air pressure range as shown in the operations manual, do not exceed. For all adjustments, repairs or cleaning of the tool, disconnect air supply. Always use dry, clean and lubricate compressed air.

## 2) TECHNICAL DATA

DESCRIPTION OF THE TOOL: The tool model SP4119/4132 is designed to strap packages with steel strap. The strap is fed around the package manually and inserted in the tool, as shown in the instructions, tensioned, cut and closed the strap with a seal joint

TOOL SIZE		
Length:		430mm – 16.9”
Width with hook:		260mm – 10.2”
Height:		310mm – 12.2”
Weight:		10.3 kgs – 22.6lbs

FEED REQUIR.		
Pressure Range:		5.5 -7 bar / 78 –99 psi
Air Comsumption:		12 L/s – 25 cuft/min

PERFORMANCES		
Max.Tension force:		9000N -6.5bar-92psi
Tensioning speed:		6mt/m
Sealing:		seal double notches
Joint strength:		80% of plastic strap strength*

\* depends of strap quality

### CHART OF TYPES

MODEL	STRAP	THICKNESS
SP4119-19mm-9000N- 3B	R 850N/mm2	0.6mm 0.024” – 1mm 0.039”
	R 1100N/mm2	0.63mm 0.025” – 0.8mm 0.031”
	R 850N/mm2	0.6mm 0.024” – 1mm 0.039”
	R 1100N/mm2	0.63mm 0.025” – 0.8mm 0.031”
SP4132-32mm-9000N- 3B	R 850N/mm2	0.6mm 0.024” – 1mm 0.039”
	R 1100N/mm2	0.63mm 0.025” – 0.8mm 0.031”

## 3) WARRANTY CONDITIONS AND LIABILITY

Greenbridge warrants all its tools and battery chargers during a period of 6 months from the shipping date document. Wear parts are warranted for 45 days, otherwise wear parts are excluded from regular warranty, wear parts are shown on spare parts list (in tool manual).

Warranty includes free replacement parts. The warranty is not valid in case of improper use, lack of maintenance, tampering, arbitrary modifications and reparations, use of non-original parts, disregard of instructions of the operation manual, or missing serial number. No compensation can be claimed for production shutdowns and for damages to people and objects due to tool defects. Greenbridge reserves the right to modify the tools and documentation without any obligation to update previous ones.

Greenbridge warrants all its batteries during a period of 120 days from the shipping date document. The manufacturer is committed to replace it with a free battery only when there are manufacturing defects that make it unfit for use.

## 4) INSTALLATION

Use always a dryer unit near the compressor and a filter-regulator-lubricator unit (Greenbridge code S100001) as close to air tool to avoid that water and dirtiness will be inlet in the valves or motors. Check daily the oil in the lubricator (we recommend oil type Synfilm32 Greenbridge code S200005). Connect the tool to air with quick connector 1/4" and use minimum 8mm or 3/8" internal diameter pipe; max length for flexible pipe 10mt between tool and regulator group. Check that your compressor / air distribution plant are able to supply the right air quantity as showed in the operation manual without loose pressure.



→ S100001



TOOL AIR CONNECTION



TOOL ACCESSORIES

## 5) OPERATING ELEMENTS AND ADJUSTMENTS

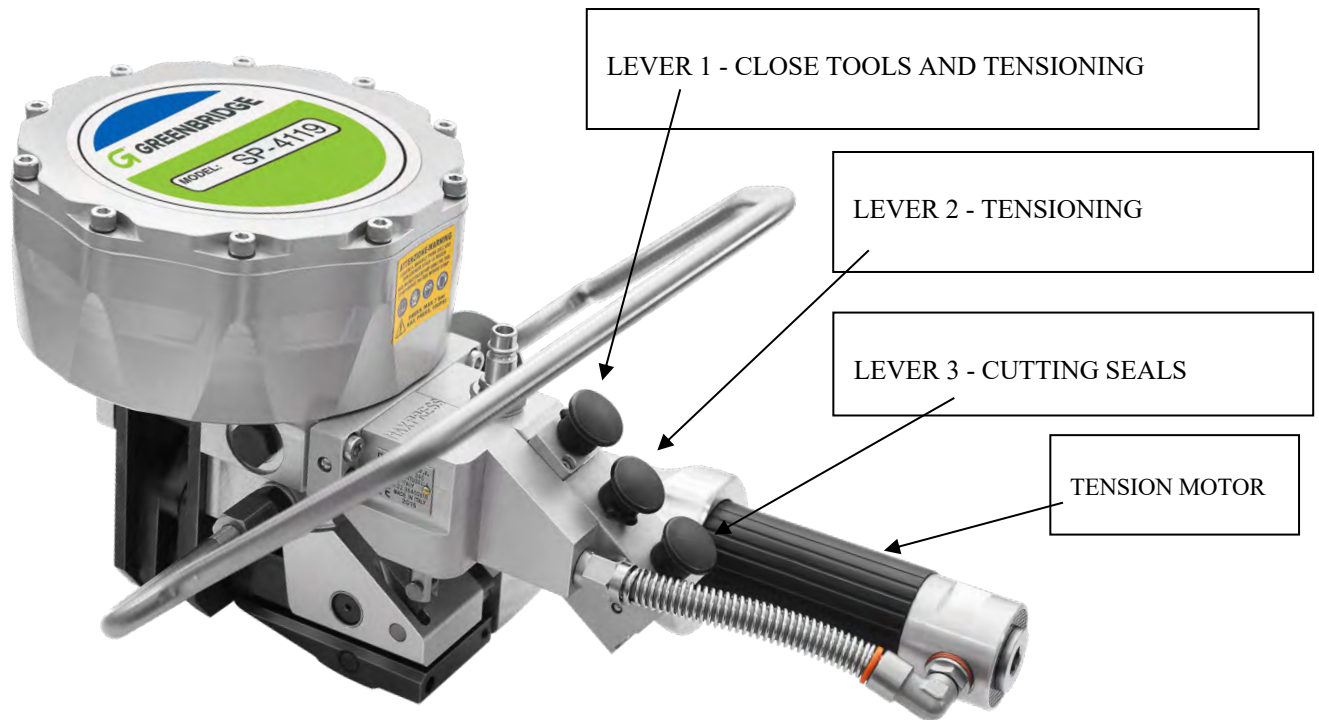

### Adjusting strap tension (pic.A):

The maximum strap tension could be adjusted with a screwdriver, depending on strap quality and dimensions, turning the screw, as shown on pneumatic motor. Turning in clockwise the force will be reduced, in counter clockwise it will be increased – do not exceed in counter clockwise –

(A)



Tension motor adjustment force

### Feedwheel gap adjustment (pic.B1-B2):

(B1)



(B2)



It is possible to adjust the height of the feed-wheel in order to change the teeth pressure on strap; unscrew the locking screw (**pic.B1**), turn the regulation screw, so that the standard height feed-wheel is 0.1-0.2mm (0.0039"-0.0078"). Turning clockwise decrease the height, turning counter clockwise increase the height (**pic.B2**), after the adjustment lock the screw

## 6) OPERATION

Make the strap slip into the seal and wind it up around the package; then make strap bottom pass a second time into the seal and bend it (**pic.C1**); push lever 1 to open the machine and load it with the strap already prepared (**pic.C2**), press lever 2 for close the machine and tensioning the strap and hold it until operation is over (**pic.C3**).

Once strap tension operation is over, press lever 3 for close the seal and cut the strap (**pic.C4**); once sealing and cutting cycle is over, it is sufficient push the lever 1 for open the tool and releasing the strap (**pic.C5**).

To check finally if the sealing is good and if the seal joint seal present of the marked recordings, this control is very important in order to understand the efficiency of the closing (**fig. C6**).

(C1)



(C2)



(C3)



(C4)



(C5)



(C6)





## 7) SERVICING - CLEANING

**BEFORE ANY SERVICE ON THE TOOL, DISCONNECT IT FROM COMPRESSED AIR LINE**



Clean by compressed air under roll and sliding plate as in the picture

## 8) TROUBLESHOOTING

PROBLEM	REMEDY
<b>The tension of strap isn't enough</b>	Check the air pressure (min.5,5 bar) Check if the filter / lubricator group is damaged or dirty. Check if the pneumatic motor isn't damaged or dirty (contact the after sale service). Check the power adjusting screw on the pneumatic motor
<b>The feedwheel slides and milling on strap</b>	Check if the feed wheel is dirty. Check if the feed wheel is damaged Adjust the gap between feed wheel and pressure button (around 0,2mm—0.008")
	Too much tension force—adjust the motor power. Check on foot if the seal support points are not damaged or worn out. Check if the strap characteristics are right for the strapping tool and application Check if the seal characteristics are right for the strap and the application
<b>The tensioned strap is sideways bended</b>	Ad just the motor power—too much tension force. Check if the strap characteristics are right for the strapping tool
<b>Hearing air leak</b>	Should be necessary replace the gaskets (contact the after sale service)
<b>The Joint efficently isn't enough</b>	Check the air pressure. Check if there are some loosened parts into sealing group Check if in the sealing group there are some damaged parts — performing maintenance (contact the after sale service). Check if the strap characteristics are right for the strapping tool Check the seal quality
<b>The strap cutting isn't correct</b>	Check the air pressure (min.5,5 bar). Check if the strap characteristics are right for the strapping Tool. There are some damaged parts — performing maintenance (contact the after sale service)
<b>The sealing / cutting phase is too slow and hearing air leak</b>	Damaged piston gaskets into cylinder (contact the after sale service) - necessary replace them
<b>The operation buttons are locked— the piston has difficul to open the tool</b>	

## 9) LAYOUT-SPARE PARTS LIST

GREENBRIDGE PART #	ITEM	DESCRIPTION	QTY		
189914	A000082	FEEDWHEEL COVER ASSEMBLED	1		
399523	A000245	3P PUSHING ASSEMBLED	1		
207732	A00740	CYLINDER ASSEMBLED	1		
	AZ10.076.4	PNEUMATIC VALVE GROUP	1		
189916	B100134	PIPE 8X10 (Lenght meters)	0,2		*
189779	B100136	ALUM.GASKET 3/8"	1		
189780	B100305	AIR CONN. 3/8-1/4 A4/Z (2151003)	1		
18918	B100306	SWING ELBOW 10 1/4 RL31	1		
189707	B100307	AIR CONN. 10 1/4 R1 920010120	1		
189672	B200104	CAMOZZI 458-33/19C	1		
19674	B200105	CAMOZZI 458-33/21C	3		
189681	B200155	CAMOZZI PISTON 458-33/23C	1		
189920	B200308	FAST AIR CONN. ANI 64MF 8X10	1		
189105	B200309	FAST AIR MALE CONN. APAG261.14	1		
189105	B300085	O-RING OR16X2	9		
189667	B300086	O-RING OR108 (D9)	6		*
189863	B300089	GASKET AIRZET PR12	3		*
189684	B300125	O-RING OR2087 (D22)	1		
189830	B300130	O-RING OR3162 (D41)	1		
189923	B300131	GASKET AIRZET PR15	1		*
189831	B300132	OIL GASKET G 17X23X3	1		
189924	B300363	DOUBLE LIPS GASKET	1		
207734	B300489	O-RING COVER	1		
189608	B400108	BEARING 6003	2		
189832	B400109	ROLLER BEARING BK1012	1		
189833	B400110	BEARING 7202 BEP	1		
190032	B500036	SCREW M5X12	2		
189276	B500045	SCREW M4X5	1		
189163	B500053	SELFLOCK.NUT M8 H10 DIN982	1		
189834	B500107	SCREW M5X6	1		
189156	B500139	SCREW M6X20	4		
189835	B500142	SCREW M8X1X10	1		
189819	B500143	SCREW M6X6	1		
189836	B500144	SCREW M8X1X14	1		
189837	B500145	WASHER M10	2		*
189784	B500146	SELFLOCK.NUT M10X1X10 ZINC	1		*
189926	B500147	NUT M10X1X8	1		
189927	B500148	SPLITPIN 2X15	2		
190040	B500372	SCREW M8X50	1		
190051	B600114	GUIDE SOCKET BM 1212	1		
189930	B600115	GUIDE SOCKET BM 1210	1		
189611	B600117	GUIDE SOCKET BMC 14x16x15	1		
189693	B600118	CIRCLIP INT J20 DIN 472	2		
189683	B600119	CIRCLIP INT J22 DIN472	1		
189840	B600122	CIRCLIP INT J47 DIN472	1		
189841	B600123	WASHER. PS 35X25X0.5	2		
189842	B600124	WASHER. PS 35X25X0.2	3		
X	B700153	PIN 5X26 UNI 707	1		

GREENBRIDGE PART #	ITEM	DESCRIPTION	QTY		
189932	B600133	CUP WASHER 20X10.2X0.8	2		
190060	B600346	SEEGER D15 UNI 7435	1		
189875	B700102	ELASTIC PIN 4X14 UNI6874	2		
189933	B700149	PIN 7X28 DIN6325	2		*
189934	B700150	ELASTIC PIN 4X24 UNI6874	1		
189846	D000870	FEEDWHEEL SPACER	1		
189770	D000910	ROLLER PIN	1		
190128	D000960	FEEDWHEEL	1	§	*
189850	D002410	WORM GEAR	1		
189851	D002420	CROWN	1		
189657	D002430	LOCKING PIN	2		*
189658	D002440	SPACER	2		
189788	D002460	JAWS SPACER	2		
189937	D002470	PISTON SHAFT WASHER	1		
189938	D002480	SPACER	1		
189664	D002490	CUTTER SHAFT	1		
189939	D002500	LINKER 19mm	2		
189666	D002510	PISTON SHAFT	1		
189685	D002520	VALVE SPRING SUPPORT	1		
189940	D002530	LINKER 25/32mm	2		
189682	D002540	VALVE CLOSER	1		
189675	D002560	VALVE PISTON	1		
189941	D002570	CILINDER AIR CONNECTION	1		
189942	D002580	PISTON	1		
189943	D002600	CILINDER	1		
189944	D002610	COVER	1		
189945	D002620	JAW 25/32mm	4		
189946	D002630	JAW 19mm 3/4"	4		
189947	D002640	ANVIL 19mm 3/4"	1		
X	D002650	ANVIL 25mm 1"	1		
189948	D002660	ANVIL 32mm 1"-1/4	1		
189949	D002670	FRONT PLATE 19mm 3/4"	1		
207936	D002680	FRONT PLATE 25mm 1"	1		
189665	D002690	FRONT PLATE 32mm 1"-1/4	1		
189950	D002700	REAR PLATE 19mm 3/4"	1		
X	D002710	REAR PLATE 25mm 1"	1		
189951	D002720	REAR PLATE 32mm 1" 1/4	1		
189694	D002780	JAWS PIN	2		*
189852	D002790	GEARBOX BEARING SUPPORT	1		
189956	D002810	PISTON PIN	2		
189957	D002820	PIN LINK	1		
189961	D002870	NUT	1		
189962	D002880	CUTTER SUPPORT	1		
189963	D002890	NUT	1		
189964	D002900	HOOK FRICTION PLATE	1		
189609	D002930	FEEDWHEEL SHAFT	1		
189965	D002970	CLUTCH PLATE	1		
189680	D002980	SPRING	1		*
189768	D003140	CUTTER 25mm -1"	1	§	*
189769	D003150	CUTTER 32mm- 1"-1/4	1	§	*
X	D003160	CLUTCH SUPPORT	1		
189619	D003190	GEARBOX BODY	1		

GREENBRIDGE PART #	ITEM	DESCRIPTION	QTY		
189967	D003200	FOOT 19mm 3/4"	1		
X	D003210	FOOT 25mm 1"	1		
189968	D003220	FOOT 32mm 1"-1/4	1		
189969	D003230	SUSPENSION HOOK	1		
189971	D003250	RIGHT BUTTONS BODY	1		
189978	D004290	AIR PIPE PROTECTION	1		
X	D005880	HANDLE GUIDE	1		
207260	D006700	PUNSCH BUTTON	3		
208138	D006730	CONTRAST ROLLER	1		
207733	D009410	COVER	1		
X	D008040	SUPP. SHAFT	1		
X	D008050	GUIDESTRAP SHAFT	1		
189618	8411035119	PNEUMATIC MOTOR	1		
202798	8411035127	PNEUM. MOTOR FOR 19 MM (5/8) SIZE STRAP	1		

COMPONENTE DESTINATO AD USURA	§	WEARING PART
RICAMBIO CONSIGLIATO A STOCK	*	PART THAT SHOULD BE STOCKED

# SP4119 / SP4132

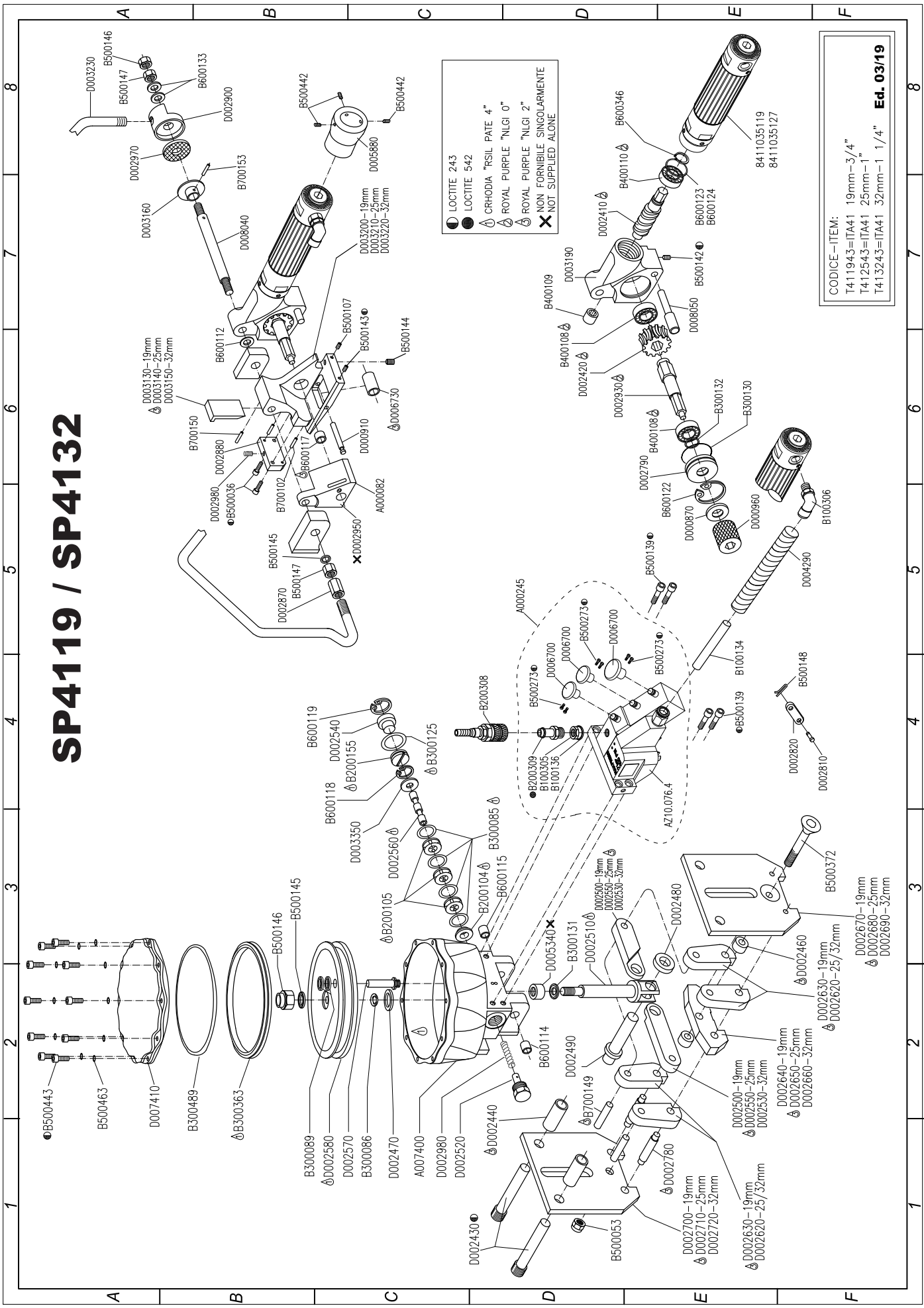

0 607 951 337  
Issue  
Stand | 05-10-07

Fig./Abb. 1

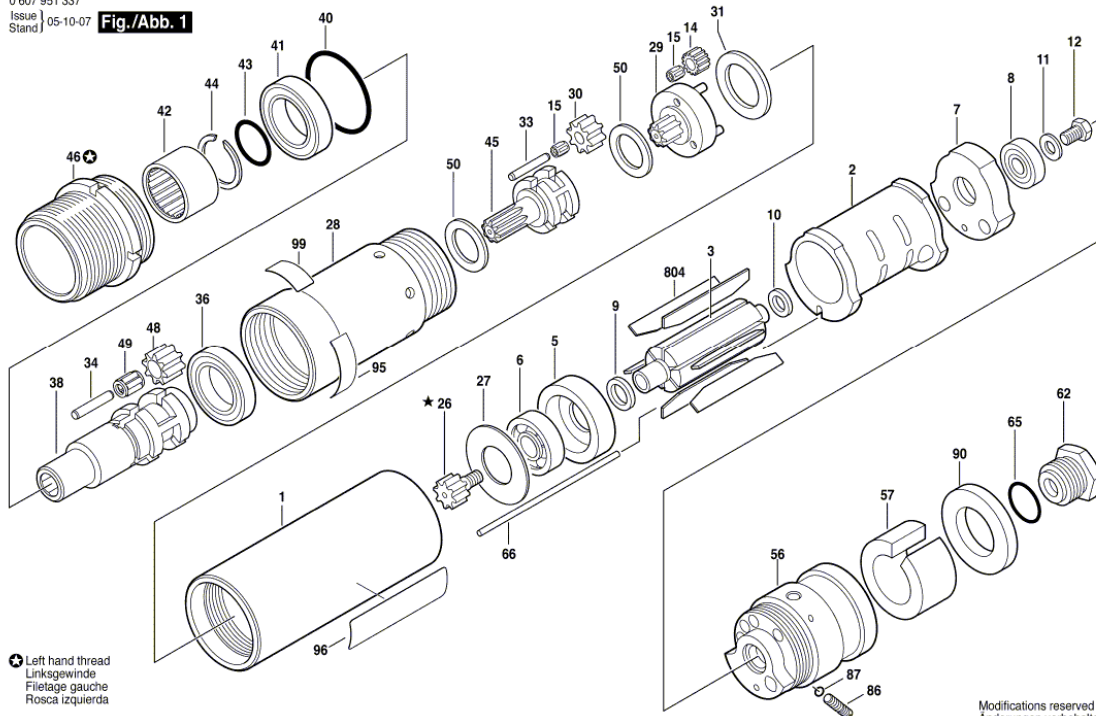

⊖ Left hand thread  
Linksgewinde  
Filetage gauche  
Rosca izquierda

★ secure with Loctite 270  
mit Loctite 270 sichern

Modifications reserved  
Änderungen vorbehalten  
Modifications réservées  
Salvo modificaciones

**BOSCH 0 607 951 447 –  
TENSION MOTOR  
SP4119/4132**

Pos.	Menge	Bestell Nr.
1	1	3 600 760 114
2	1	3 604 090 062
3	1	3 604 220 025
5	1	3 605 700 005
6	1	3 600 905 039
7	1	3 605 700 006
8	1	3 600 905 148
9	1	2 600 202 013
10	1	2 600 202 014
11	1	2 916 011 012
12	1	2 911 061 150
14	3	3 606 316 000
15	6	3 600 913 000
26	1	3 606 300 002
27	1	3 600 101 001
28	1	3 606 334 091
29	1	3 606 337 071
30	3	3 606 316 001
34	2	3 603 201 044
36	1	3 600 900 016
38	1	3 606 337 208
40	1	2 600 210 024
41	1	3 600 905 145
42	1	3 600 910 018
43	1	1 900 210 113
44	1	2 916 650 011
45	1	3 606 337 105
46	1	3 603 344 055
48	3	3 606 316 053
49	3	3 600 903 001
50	2	3 600 101 024
56	1	3 605 190 191
57	1	3 601 010 002
62	1	3 603 458 019
65	1	3 600 210 036
66	1	3 604 710 051
86	1	3 603 436 032
87	1	3 600 210 015
90	1	3 600 105 002
95	1	3 601 106 047
96	1	3 601 110 331
804	1	3 607 030 249

0 607 951 337  
Issue  
Stand | 05-10-07

Fig./Abb. 5

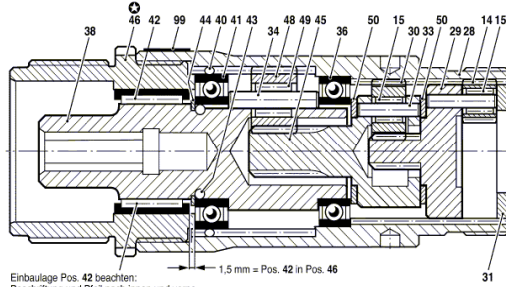

Einbaulage Pos. 42 beachten:  
Beschriftung und Pfeil nach innen und vorne  
nicht lesbar (linksdrehend, rechts blockierend)

Dimensions in mm  
Maße in mm  
Cotes en mm  
Medidas en mm

Torque values  
Anzugsmomente  
Couple de serrage  
Paras de apriete  
Pos. 12 = 3,0 - 3,5 Nm  
26 = 4,0 - 5,0 Nm  
29 = 40,0 - 48,0 Nm  
46 = 40,0 - 44,0 Nm  
56 = 15,0 - 18,0 Nm

★ secure with Loctite 270  
mit Loctite 270 sichern

⊖ Left hand thread  
Linksgewinde  
Filetage gauche  
Rosca izquierda

Modifications reserved  
Änderungen vorbehalten  
Modifications réservées  
Salvo modificaciones

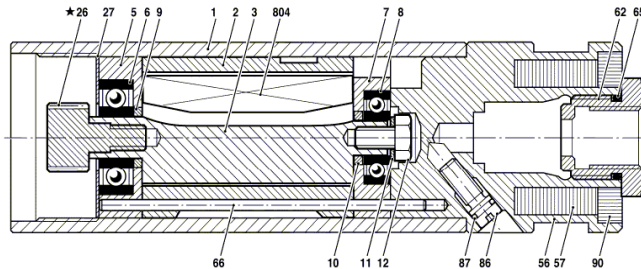

## CE DECLARATION OF CONFORMITY

Greenbridge declares under own responsibility that the under mentioned machinery, to this declarations refers, is in conformity with following standard or standardised documents **98/37/EEC, EN292/1, EN292/2.....**

Greenbridge .....

**MODEL:**  
**SP4119/4132**



**MACHINE TYPE:**

**PNEUMATIC STEEL STRAPPING TOOL SEAL JOINT**

# GREENBRIDGE

6277 Heisley Road Mentor, Ohio 44060

Tel. 440-357-1500 Fax 440-352-9553 [www.greenbridge.com](http://www.greenbridge.com)











